

Ball-impact and shock resistant LED safety luminaire with optimised light distribution for the illumination of areas. Powder-coated aluminium housing with slim design, perfect for use in environments with high mechanical stresses and in sports facilities.

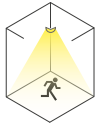

Technical data

Material:	sheet steel powder-coated
Illuminant:	1 x 3,5W LED-module
Luminous flux:	491 lm
Nominal voltage AC:	230V ±10% 50/60 Hz
Nominal voltage DC:	176 - 264 V
Nominal current AC:	33 mA
Nominal current DC:	25 mA

Apparent power:	7,6 VA
Effective power:	5,7 W
Inrush current:	8 A / 50 µs
Protection class:	I
Input terminals:	2.5mm ² feed through wiring
Temperature ta:	-15...+40 °C
Impact resistance:	IK10

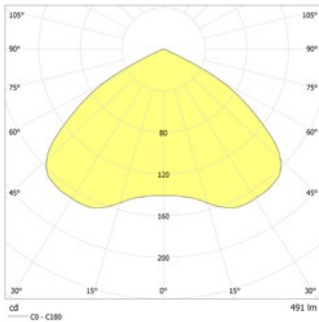

Ceiling mounting: Minimum illumination 1.0lx (middle of escape route), Maintenance factor 0.8

5.5	6.4	15.9
6.0	6.6	16.5
6.5	6.7	17.1
7.0	6.7	17.6
7.5	6.7	18.0
8.0	6.5	18.3
8.5	6.3	18.6
9.0	5.9	18.8
9.5	5.4	19.0
10.0	4.8	19.0

Minimum illumination 1.0lx (area illumination), Maintenance factor 0.8

5.5	4.7	12.9
6.0	4.9	13.6
6.5	4.9	13.7
7.0	4.9	14.7
7.5	4.8	15.4
8.0	4.8	15.8
8.5	4.7	15.9
9.0	4.6	16.2
9.5	4.5	16.6
10.0	4.2	17.0

Articles

SN 8030.2 AP -12 SHB LED J/SV

Colors	RAL 7015	RAL 9016	RAL (special)
Art. no.	104419486	104419587	104419688

ceiling mounting for exposed wiring Light colour: 4000 K Protection category: IP40

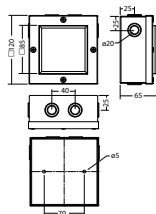

SN 8030.2 D -12 SHB LED J/SV

Colors	RAL 7015	RAL 9016	RAL (special)
Art. no.	101832317	101832115	101832418

ceiling mounting Light colour: 4000 K Protection category: IP40

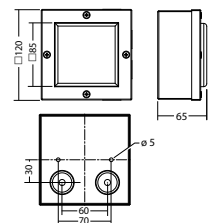

Name	Accessories	Art. no.
J-ET 9/24 SVmax.24VDC,320mAconst	spare part	101420267
LM 8030.2 1(12V)/4K SHB 24V RAL9016 LED Modul	spare part	104487790